

Royce

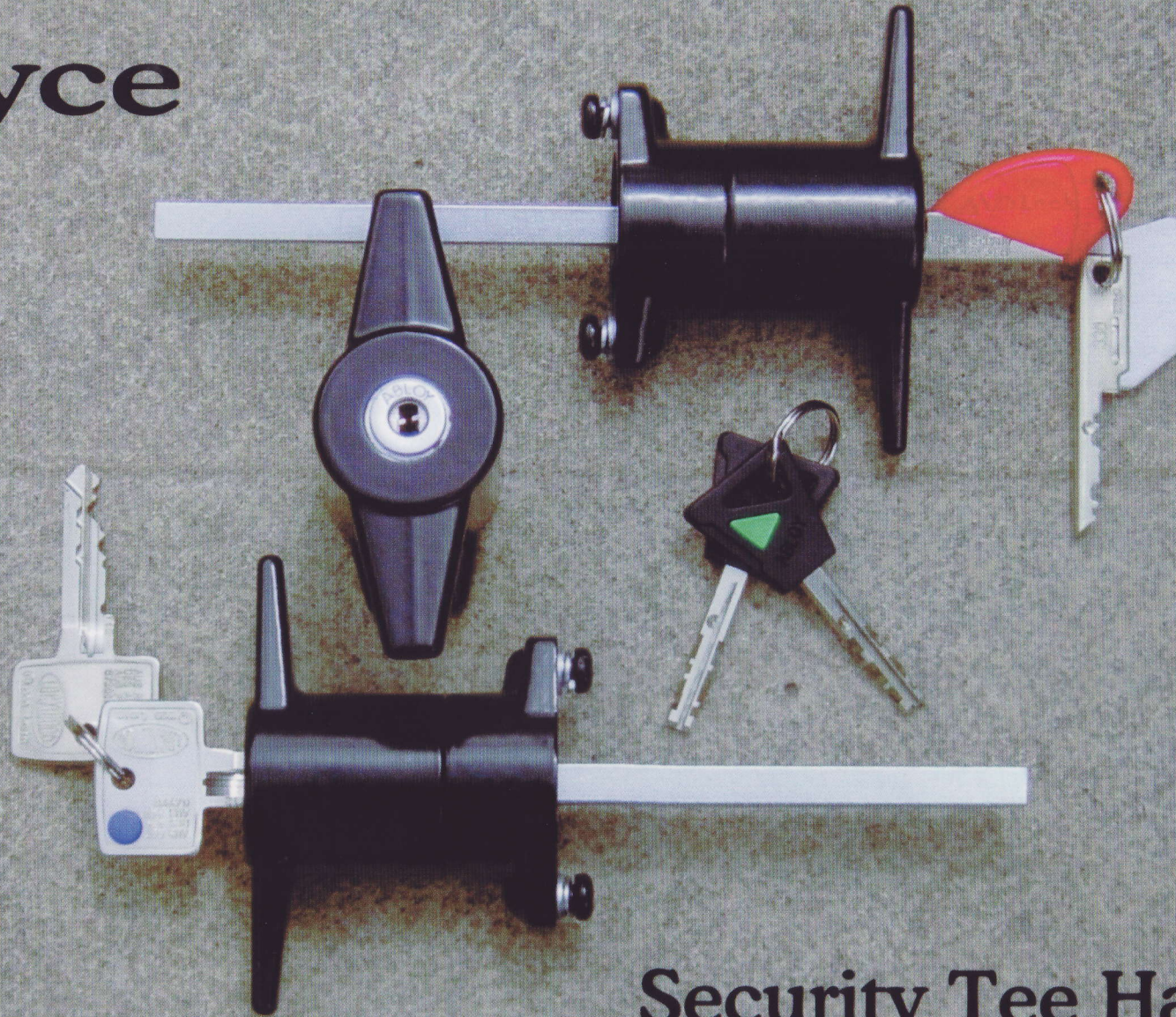

Security Tee Handles

ASSEMBLY INSTRUCTIONS

1. FIT 'DRIVE SHAFT' INTO 'BARREL' AND SECURE WITH SEL-LOK PIN.
2. FOR 'KEY REMOVAL' OPERATION, ORIENTATE THE 'DRIVE SCREW' AS SHOWN BOTTOM RIGHT WITH BOTH ENDS OF SLOT VISIBLE AND BLADE VERTICAL.
HOLD THE 'LEFT HAND NUT' WITH WINGS VERTICAL AND SCREW ON UP TO SHOULDER.
BACK OFF SLIGHTLY UNTIL 'NUT' WINGS ARE AGAIN VERTICAL.
3. FOR 'KEY CAPTIVE' OPERATION, ORIENTATE THE 'DRIVE SCREW' AS SHOWN TOP RIGHT WITH ONE END OF SLOT VISIBLE AND BLADE HORIZONTAL.
HOLD THE 'LEFT HAND NUT' WITH WINGS HORIZONTAL AND SCREW ON 1.25 TURNS.
ENSURE END OF 'SCREW' IS FLUSH WITH FACE OF 'NUT'.
4. SLIDE THE 'NUT AND DRIVE SCREW' ASSEMBLY INTO THE 'BARREL', AND AND FIT 'DRIVE SCREW STOP PIN'.
5. FIT 'CYLINDER PLUG' INTO 'T-HANDLE' WITH KEY OUT.
6. SLIDE 'DRIVE SHAFT AND BARREL' ASSEMBLY INTO 'T-HANDLE' AND FIX WITH 'M3 GRUB SCREW'.
7. FIT 'T-HANDLE STOP PIN' INTO HOLE DESIGNATED 'CW' FOR CLOCKWISE ROTATION OF HANDLE, OR HOLE DESIGNATED 'ACW' FOR ANTI-CLOCKWISE ROTATION OF HANDLE.
8. SLIDE 'FLANGE' OVER 'DRIVE SHAFT' AND FIT 'WAVE WASHER', FOLLOWED BY 'CIRCLIP'.

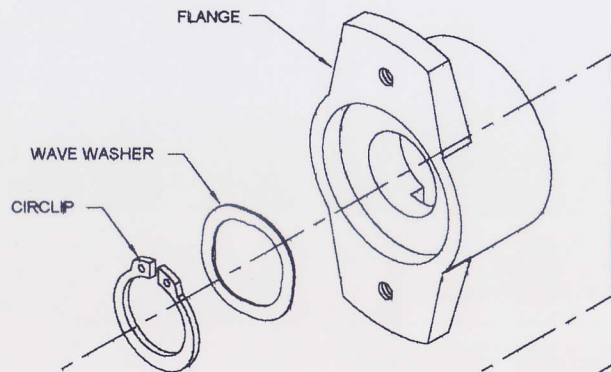

T-HANDLE
STOP PIN
SEE NOTE

DRIVE SHAFT

ROYCE SECURITY T-HANDLE
ROYCE SECURITY PRODUCTS

T-HANDLE EXPLODED VIEW AND INSTRUCTIONS

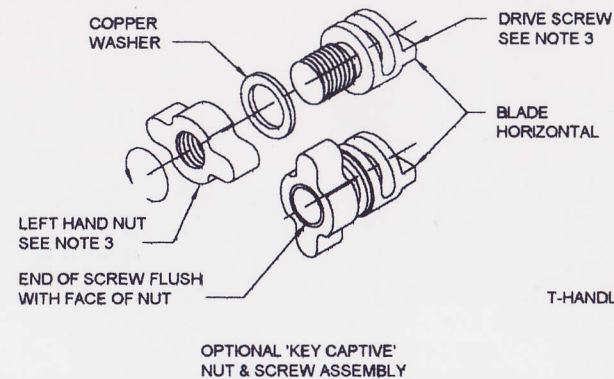

BLADE VERTICAL

DRIVE SCREW
SEE NOTE 2

LEFT HAND NUT
SEE NOTE 2

CYLINDER
PLUG

LAZY CAM

M3 GRUB SCREW

DRIVE SCREW
STOP PIN

DRIVE SHAFT
SEL-LOK PIN

BARREL

T-HANDLE

AVAILABLE FROM